

The **GRS-DUO-15** is designed to work with 15mm flexible plastic barrier pipework commonly used for central heating systems in modern buildings.



The dual plate design allows for the location and alignment of the initial pipework to be set during the first fix plumbing phase, with the subsequent penetration through the plasterboard behind the radiator then covered and sealed against air leakage during the course of the second fix works.

The versatility of the system allows it to be installed in a wide range of details and with both blockwork and stud wall constructions. The unique single central fixing removes the need for plasterboard fixings and allows the system to be fitted securely with a variety of plasterboard and radiator offsets.

Manthorpe

GRS-DUO 15mm Radiator Pipe Guide & Seal

Components Components within the GRS-DUO 15mm system

Mount Plate

Installation Point:
1st Fix

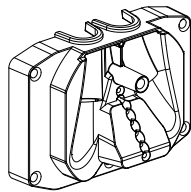

Cover Plate

Installation Point:
2nd Fix

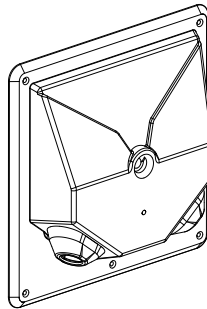

Fitting Instructions

MBP_GU_1279_01

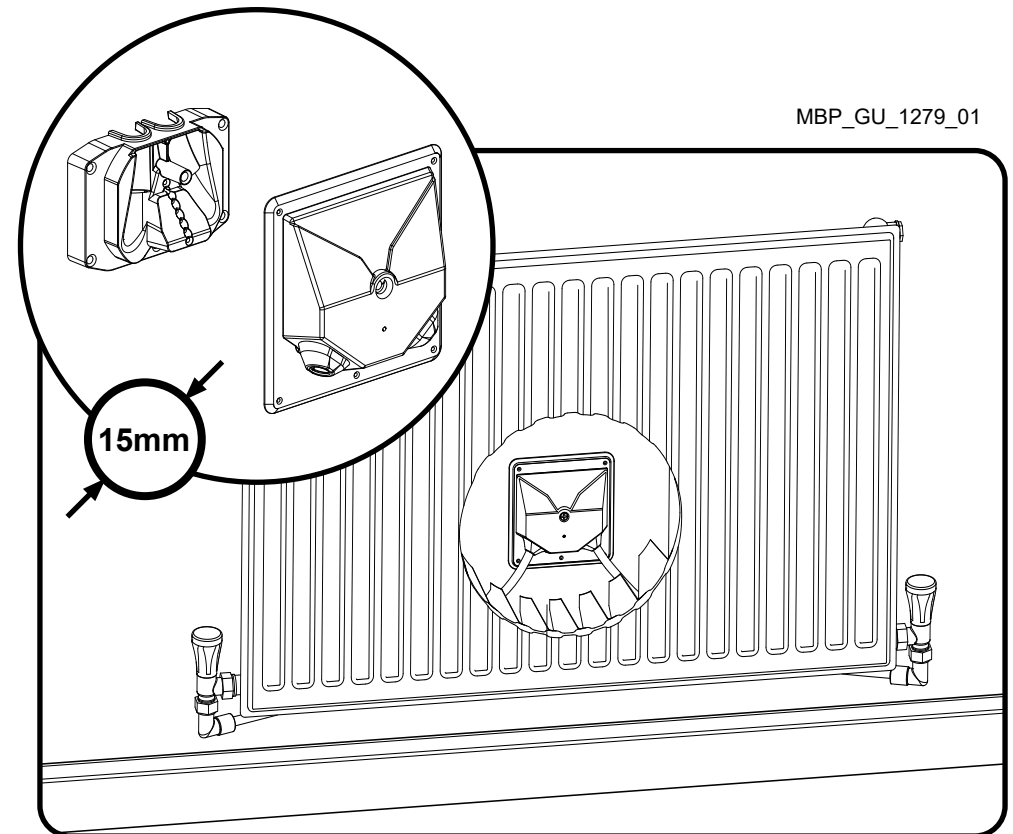

Screw fixings for both the mount and cover plate not included.

15mm

Screw fixings not included.

Pipe Routing Options

The **GRS-DUO-15** has the versatility to be fitted in a wide range of details and will work with pipework coming from above on ground floors, below on upper floors or from the side under window details.

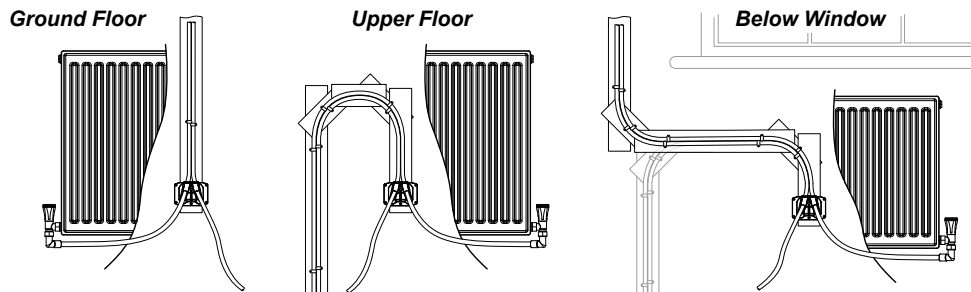

*Images are illustrative of pipe routing options

Manthorpe Building Products Limited

Manthorpe House, Brittain Drive, Codnor Gate Business Park, Ripley, Derbyshire DE5 3ND
T: (01773) 303 000 F: (01773) 303 300 E: mbp.care@manthorpebp.co.uk
W: www.manthorpebp.co.uk



GRS-DUO 15mm Radiator Pipe Guide & Seal Installation:

Preparation

1. Run the pipework towards the required location, using detection tape behind the pipes. Mark the location for the mount plate, centrally about the intended position for the radiator and 200mm above the height of the radiator valve connection points.

2. Thread the pipes through the mount plate so that they sit in the guide channels. Ensure that enough excess pipe is left exposed on each side to reach both radiator valves.

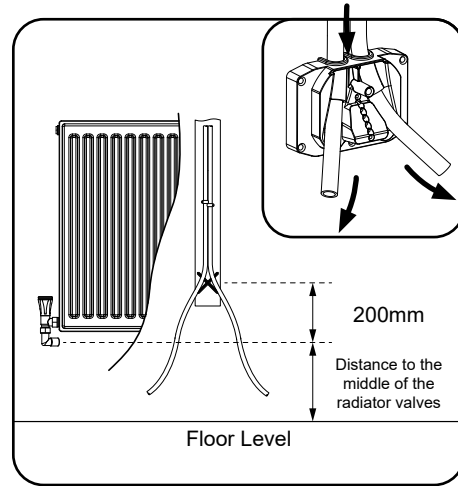

Installation

3. A – When fixing to blockwork:

Use the central fixing boss; secure with a suitable length and type of fixing for the substrate. Alternatively, the five secondary mounting holes can also be used to secure the mount plate¹.

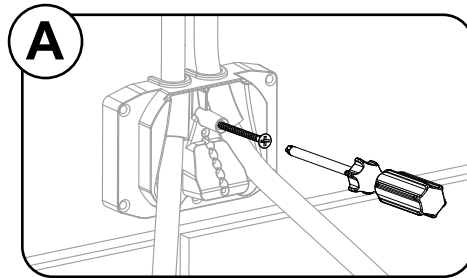

3. B – When fixing to a pattress board:

Cut a 102mm dia. penetration through the board using a hole saw. Push the mount plate through from behind and secure with appropriate length wood screws through the fixing holes on the outer flanges.

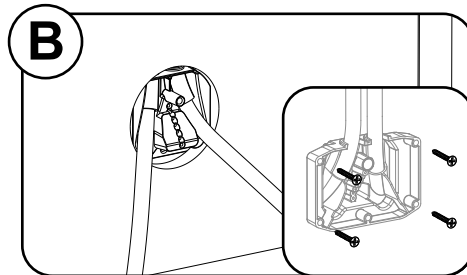

3. C – When fixing to mid-stud noggin:

Position a noggin at least 17mm back from the face of the studwork. Place the mount plate onto the noggin and secure through the central boss or outer holes¹.

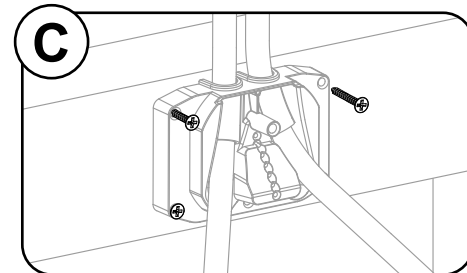

¹In most cases, the central screw boss should be sufficient, with the five secondary fixing points available for additional/alternative alignment or anchoring.

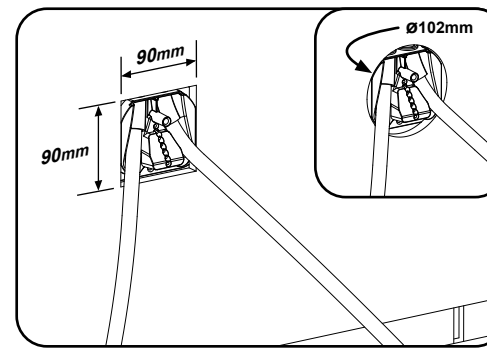

4. When dry lining, mark out and cut a 90 x 90mm square, or 102mm dia. hole in the plasterboard. Plaster the wall as normal, being careful not to plaster over the hole.

The wall can then be painted at this stage.

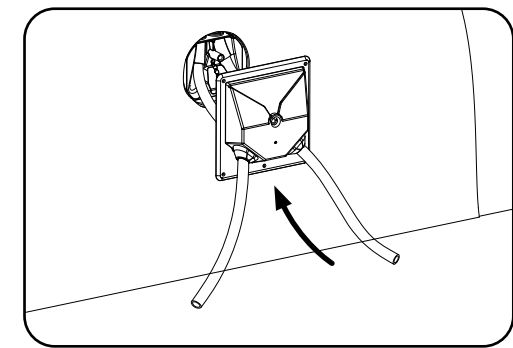

5. Thread the two pipe lengths through the correct grommets on the cover plate, ensuring that grommets are angling downward and the rear perimeter seal is facing towards the wall. Slide the cover plate up the pipework towards the mount plate and the wall.

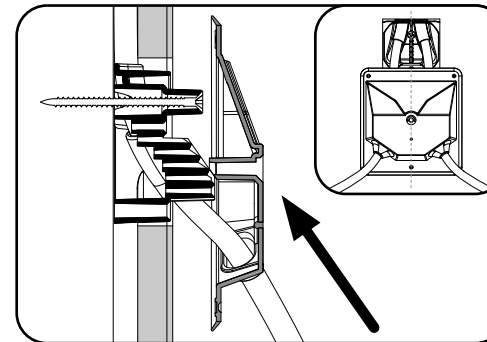

6. Ensure that the cover plate is aligned centrally with the mount plate and then slide it up the pipes until it sits tight against the plastered wall.

In order to make an airtight seal, push the cover plate firmly upward prior to fixing, to fully compress the seal against the wall.

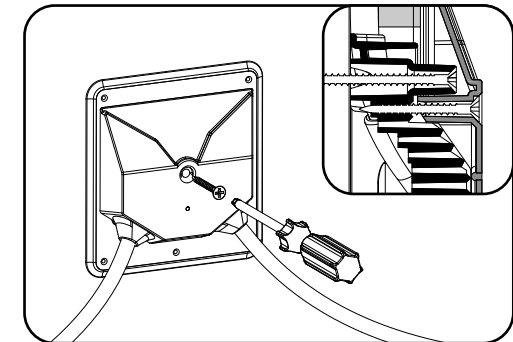

7. Once sat squarely against the wall, a single fixing screw (4mm x *minimum* 50mm long) should be pushed through the central screw boss on the cover plate and screwed into one of the appropriate pilot holes in the mount plate to secure it tightly to the wall.

The five secondary fixing points can also be used for additional alignment or anchoring to uneven walls, or act as an alternative to the central fixing if the mount plate has not been used.

8. Finally, following the radiator manufacturers installation guidance, fix the radiator to the wall and securely connect both pipes to the radiator valves.